

# Mirror Station<sup>®</sup> remote control

## ■ Instruction manual for Remote Control

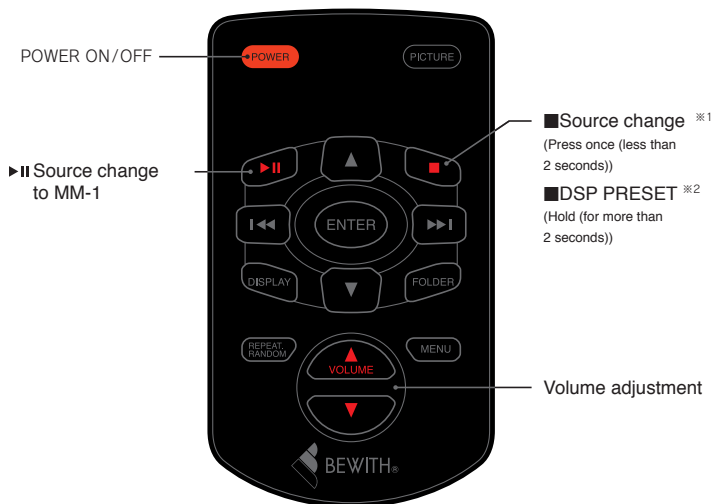

※1 ● Press STOP button (less than 2 seconds) for source change mode.

● The order of source change is as follows.  
MM1 → OPT → COAX → LINE → MINI → MM1.....

● The change is effective 2 seconds after the selection.

● Hold STOP button (more than 2 seconds) for DSP PRESET mode.

※2 ● The order of PRESET change is as follows.

PRESET1 → PRESET2 → PRESET3 → PRESET4 → PRESET5 → PRESET1.....

● The change is effective 2 seconds after the selection.

## ■ Replacement of battery / Handling of Remote Control

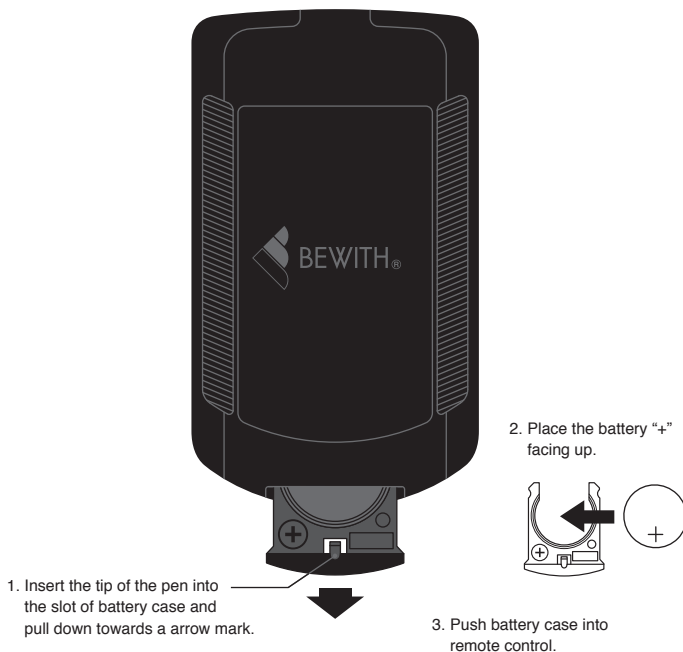

● Do not expose remote control to direct sunlight or high temperature.

● Face the remote sensor toward AZ-1's remote sensor window for control.

● Direct sunlight will not enable the remote control to work properly.

● Do not charge remote control battery. It may cause the battery fluid discharge.

● If battery fluid discharges, clean the battery fluid and replace a new battery.

● Replace the battery to a new battery when the remote control is ineffective.

● We are not responsible for any loss of setup data or damages of equipment that may occur from improper use or installation.

※ The battery is not covered by warranty.  
Please use a coin cell battery (CR2025) for replacement.